

REVISIONS			
LTR	DESCRIPTION	DATE	APPROVED
A	NEW DRAWING		

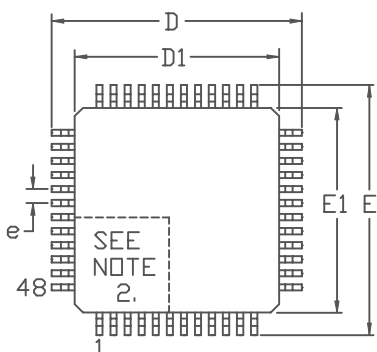

SEE DETAIL "A"

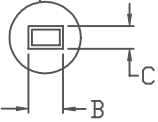
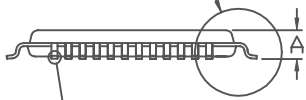

NOTES:

1. DIMENSIONS D1 AND E1 INCLUDE MOLD MISMATCH, BUT DO NOT INCLUDE MOLD PROTRUSION; ALLOWABLE PROTRUSION IS 0.25 MM PER SIDE.
2. DETAILS OF PIN 1 IDENTIFIER ARE OPTIONAL BUT MUST BE LOCATED WITHIN THE ZONE INDICATED.
3. ALLOWABLE DAMBAR PROTRUSION IS 0.08 MM TOTAL IN EXCESS OF THE B DIMENSION; AT MAXIMUM MATERIAL CONDITION. PROTRUSION NOT TO BE LOCATED ON LOWER RADIUS OR FOOT OF LEAD.
4. CONTROLLING DIMENSIONS: MILLIMETERS.

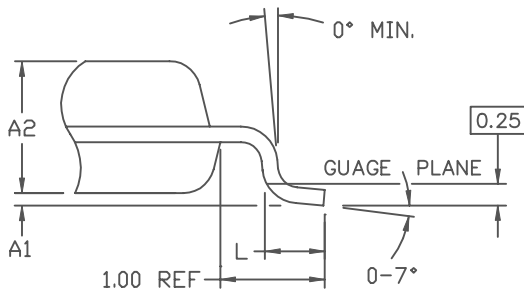

DETAIL A

DIMENSIONS ARE IN MILLIMETERS

DIM	MIN	MAX
A	-	1.20
A1	0.05	0.15
A2	0.95	1.05
D	8.80	9.20
D1	7.00 BSC	
E	8.80	9.20
E1	7.00 BSC	
L	0.45	0.75
e	0.50 BSC	
B	0.17	0.27
C	0.09	0.20

SUGGESTED PAD LAYOUT
48LD TQFP, 7 x 7 x 1.0

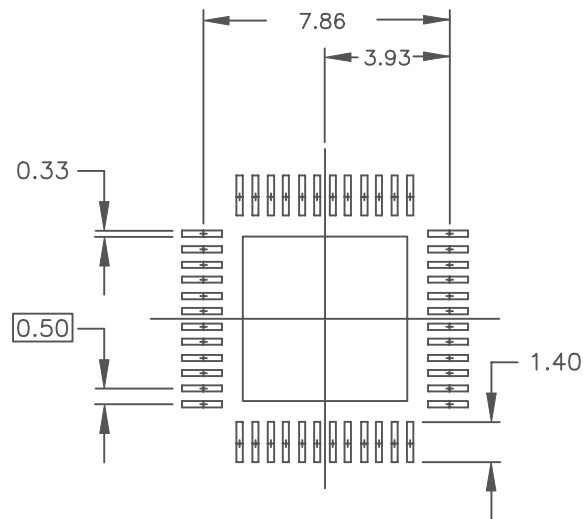

SIGNATURE	DATE
DOC. CONTROL:	
ENGR. MGR:	
MFG. ENGR:	
CHECKED BY:	
DRAWN BY: C.SELLS	8/95



TITLE MARKETING OUTLINE, 48 LD. TQFP 7 X 7 X 1.00 MM BODY			
SIZE A	FSCM NO	PART NO. 56-G4016-001	REV A
SCALE N/A	SHEET 1 OF 1		

DO NOT SCALE DWG.